

Safety & Installation Instructions

v1.3-01.23

These instructions are provided for your safety in order to prevent the risk of Fire, Electric shock or Injury. It is vitally important that they are read in their entirety before installing your fitting. Please retain for future reference.

1. If you are in any doubt consult a qualified electrician as to the installation of the fitting. Install in accordance with current IEE wiring regulations. It is recommended that this fitting is installed by a qualified electrician.
2. Ensure that the electrical supply is OFF. Disconnect the electrical supply at the fuse-board.
3. If removing an existing fitting first, note all wiring connections: record which of the house wires is connected to the live, neutral and earth terminals.
4. Carefully identify where the supply cable is (and check there are no other cables in the area) to avoid damage to concealed wiring during installation.
5. Position the light where desired ensuring that there is suitable support adjacent to where you will connect to the house supply and mark position of fixing holes, before drilling appropriate holes as below.
6.
 - a. Brick or masonry: Drill holes into which the wall plugs tightly fit, then insert wall plugs.
 - b. Wood: No hole necessary (unless small pilot hole required), screws can be screwed directly into the timber.
 - c. Plaster/Cavity: Special cavity wall fittings are required, rather than provided fixings. These are widely available from good hardware or DIY store and should come with their own instructions that must be followed. It may be easier to relocate the fitting so that you screw directly into a timber joist or beam.
7. Support the fitting so that no strain is applied to the wiring when making the electrical connections. If necessary get a colleague to help.
8. Electrical connection: this light fitting must be earthed. Make connections following the diagram below using the terminal block supplied. A small flat-head screwdriver is required.

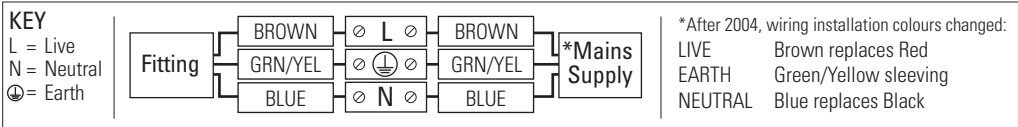

9. Double check all the connections are secure and that no loose strands of wire are left out of the connector. Ensure the lid of the terminal block is closed securely after making the connections.
10. Check that no wires are trapped behind or within the fitting and complete the installation, referring to the Installation diagram inside.
11. Fit the correct type and wattage of lamp (or less). Be careful not to overtighten the lamp.
12. Switch on at the fuse-board. Your light fitting is now ready for use.

Other Important Information

Switch off at mains before changing lamp(s). Never fit a lamp of greater wattage than recommended. Ensure children do not play with the light fitting. Dispose of old lamps carefully. Never leave a fitting without a lamp in position (or someone can accidentally touch the contacts). Adjust fitting only when power to the fitting is off and has been left to cool. If the external flexible cable or cord of this luminaire is damaged, it shall be exclusively replaced by the manufacturer or his service agent or a similar qualified person in order to avoid a hazard.

Cleaning and Maintenance

Metal finishes should only be cleaned with a soft, dry cloth. Do not use polishes or abrasives. Glass can be cleaned by hand, using a soft damp cloth with a diluted mild detergent (nonabrasive) or suitable glass cleaner if necessary. Switch off power to the fitting before cleaning. Spare parts are available for this product, please contact us on the details below.

Established in 1990, Original BTC manufactures relaxed, familiar lighting for traditional and contemporary homes. All products are hand-assembled in Oxfordshire from high quality components, produced in the UK.

ORIGINALBTC.COM
+44 (0)1993 882 251
UNIT 21 / 22 AVENUE ONE, STATION LANE, WITNEY, OX28 4XZ, ENGLAND



Ship's Well Glass Light

DP7207 & DP7207/M

Instruction Manual

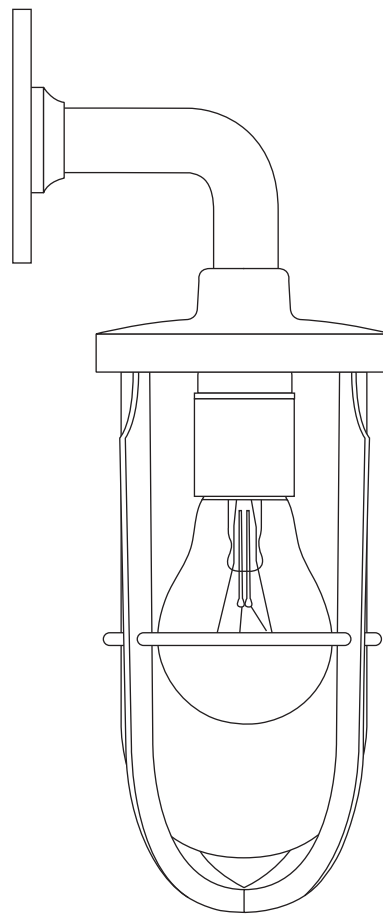

Ship's Well Glass Light
DP7207

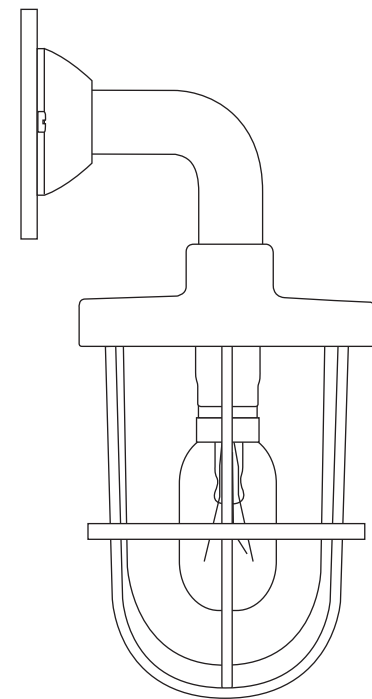

Miniature Ship's Well Glass Light
DP7207/M

ORIGINAL BTC
BRITISH LIGHTING MANUFACTURERS
LONDON - PARIS



Ship's Well Glass Light

DP7207 & DP7207/M | 230V AC 50Hz | IP54

| LAMP GUIDANCE DP7207 | | | | |
|------------------------|-------------|--------------|---|-----------|
| BASE | SHAPE | TYPE* | | WATTAGE** |
| E27 | GLS BALL | INCANDESCENT | ✓ | 60W MAX |
| | | CFL | ✓ | 15W |
| | | ECO-HALOGEN | ✓ | 28W |
| | | LED | ✓ | 10W |
| LAMP GUIDANCE DP7207/M | | | | |
| BASE | SHAPE*** | TYPE | | WATTAGE** |
| Ba15d | APPLIANCE | INCANDESCENT | ✓ | 15W MAX |
| | | CFL | ✗ | N/A |
| | | ECO-HALOGEN | ✗ | N/A |
| | | LED | ✓ | 2W |

* Warm white (2700K) lamps recommended. We recommend the use of low energy LED lamps with our products.
 ** Wattage value provided as a guide to suitable lamps. Lower wattage than stated may be used.
 *** Appliance lamps are often used in ovens, sewing machines, salt lamps and fridges.

Contents

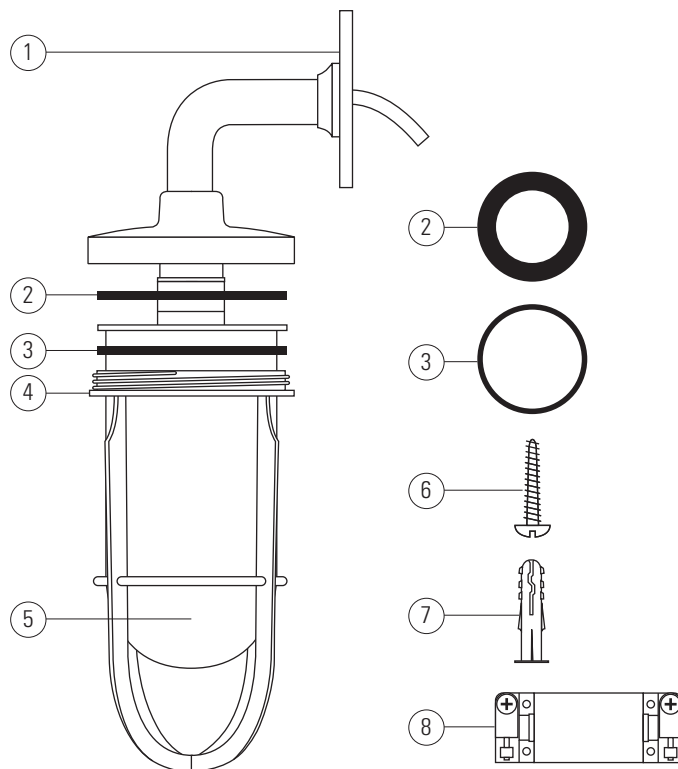

Contents

- 1 - Backplate, arm & pan casting
- 2 - Wide gasket
- 3 - Narrow gasket
- 4 - Guard*
- 5 - Well glass
- 6 - Fixing screws (x3)**
- 7 - Rawl plugs (x3)**
- 8 - Connector

*Unscrew guard from pan to remove glass and insert light bulb. Ensure tight fit when screwing back in.
 ** 7207/M supplied with x2 screws and rawl plugs.

Required for Installation

- Screwdriver, flat-head
- Small screwdriver, flat-head
- Drill (if holes are required)

PLEASE READ THE INSTRUCTIONS ON THE REVERSE BEFORE YOU BEGIN INSTALLING YOUR LIGHT

Installation Diagram

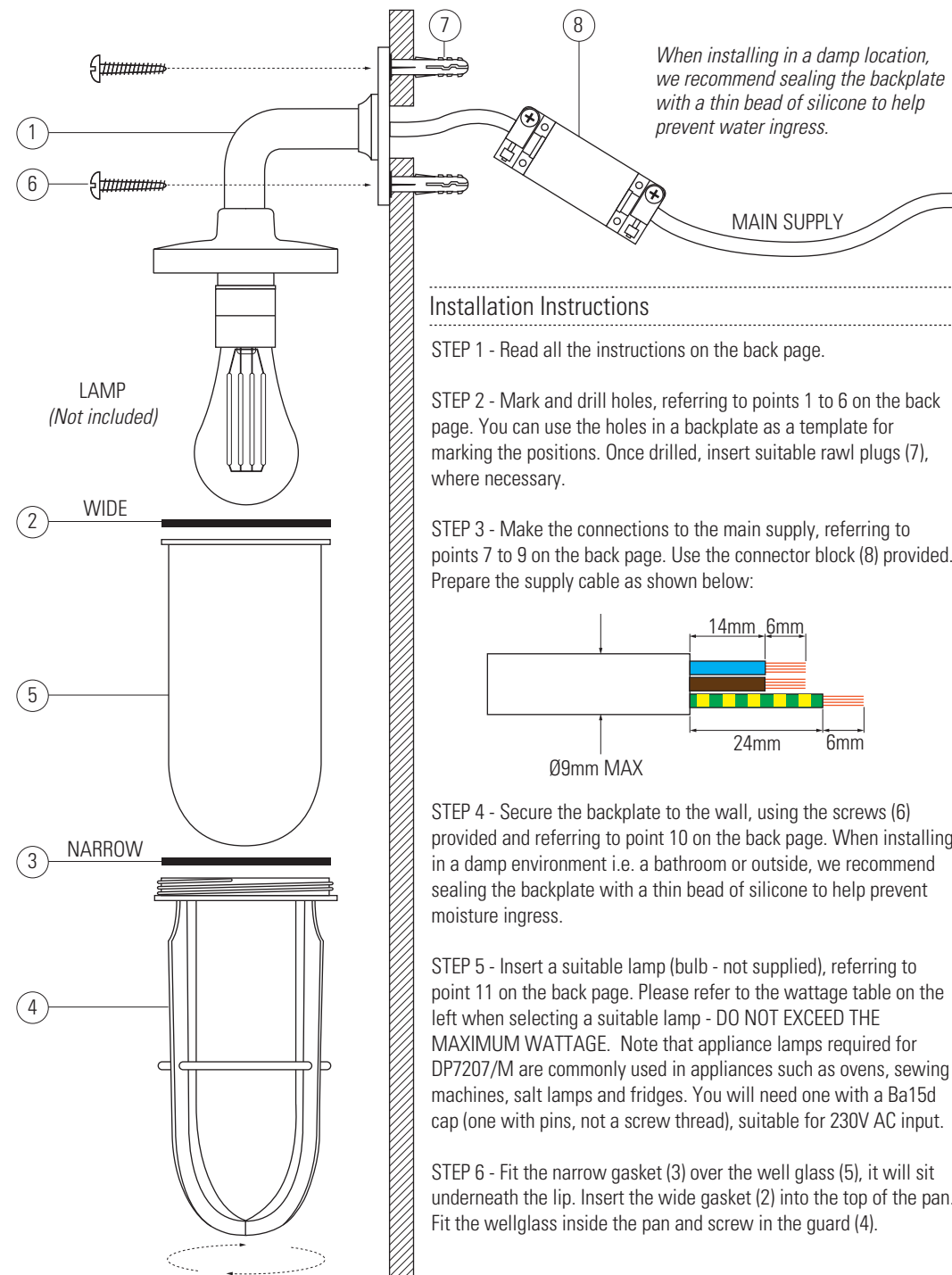

Installation Instructions

STEP 1 - Read all the instructions on the back page.

STEP 2 - Mark and drill holes, referring to points 1 to 6 on the back page. You can use the holes in a backplate as a template for marking the positions. Once drilled, insert suitable rawl plugs (7), where necessary.

STEP 3 - Make the connections to the main supply, referring to points 7 to 9 on the back page. Use the connector block (8) provided. Prepare the supply cable as shown below:

STEP 4 - Secure the backplate to the wall, using the screws (6) provided and referring to point 10 on the back page. When installing in a damp environment i.e. a bathroom or outside, we recommend sealing the backplate with a thin bead of silicone to help prevent moisture ingress.

STEP 5 - Insert a suitable lamp (bulb - not supplied), referring to point 11 on the back page. Please refer to the wattage table on the left when selecting a suitable lamp - DO NOT EXCEED THE MAXIMUM WATTAGE. Note that appliance lamps required for DP7207/M are commonly used in appliances such as ovens, sewing machines, salt lamps and fridges. You will need one with a Ba15d cap (one with pins, not a screw thread), suitable for 230V AC input.

STEP 6 - Fit the narrow gasket (3) over the well glass (5), it will sit underneath the lip. Insert the wide gasket (2) into the top of the pan. Fit the wellglass inside the pan and screw in the guard (4).